

WINDOW SCHEDULE				SYMBOL	<input type="checkbox"/>
MARK	SIZE	QUAN.	DESCRIPTION		
A	4'-4" x 5'-2"	2	FIXED		
B	2'-8" x 6'-2"	7	D.H.		
C	5'-8" x 8'-6"	2	FIXED WITH ELLIPTICAL HEAD*		
D	2'-8" x 6'-2"	2	D.H. W/ 14" TRANSOM*		
E	6'-0" DIA.	2	FIXED CIRCLE HEAD*		
F	6'-4" x 5'-9"	1	PALLADIAN SPECIAL DESIGN*		
G	2'-6 1/2" x 3'-3"	2	VELUX SKYLIGHT VS-304**		
H	2'-6 1/2" x 4'-7 1/2"	8	VELUX SKYLIGHT VS-308**		
J			NOT USED		
K	2'-8" x 5'-2"	4	D.H.		

ALL WINDOWS ARE INSULATED AND WEATHERSTIPPED.
 VERIFY LOCAL CODE EGRESS WINDOW REQUIREMENTS PRIOR TO CONSTRUCTION.
 VERIFY WINDOW MODEL NUMBERS AND SIZES WITH MANUFACTURER BEFORE STARTING CONSTRUCTION.
 ** SEE BUILDING ELEVATIONS.
 VERIFY SKYLIGHT INSTALLATION REQUIREMENTS BEFORE CONSTRUCTION. IF CURB INSTALLATION IS RECOMMENDED DUE TO CLIMATIC CONDITIONS, MODEL NUMBER AND/OR OPENING SIZE MAY VARY.

DOOR SCHEDULE				SYMBOL	<input type="checkbox"/>
MARK	SIZE	DESCRIPTION	QUAN.		
1	3'-0" x 6'-8" x 1 3/4"	EXT. HWD., (2) 12" SIDLTS., 14" TRANSOM	1		
2	2'-8" x 6'-8" x 1 3/8"	INTERIOR HARDWOOD	4		
3	2'-0" x 6'-8" x 1 3/8"	INTERIOR HARDWOOD	2		
4	4'-0" x 6'-8" x 1 3/8"	INTERIOR BIFOLD	2		
5	2'-8" x 6'-8" x 1 3/4"	EXT. HARDWOOD, 1HR. FIRE RATED	1		
6	2'-6" x 6'-8" x 1 3/8"	INTERIOR HARDWOOD	2		
7	5'-0" x 6'-8" x 1 3/8"	INTERIOR BIFOLD	2		
8	2'-8" x 6'-8" x 1 3/4"	EXTERIOR HARDWOOD, FRENCH	1		
9	16'-0" x 7'-0" x 1 3/4"	GARAGE DOOR	1		
10	2'-4" x 6'-8" x 1 3/8"	INTERIOR HARDWOOD	1		
11	PR. 2'-0" x 6'-8" x 1 3/8"	INTERIOR HARDWOOD	1		
12	PR. 2'-6" x 6'-8" x 1 3/8"	INTERIOR HARDWOOD	2		
13	6'-0" x 6'-8" x 1 3/4"	EXT. HARDWOOD, SLIDING FRENCH, 12" TRANS.	1		
14	3'-0" x 6'-8" x 1 3/4"	EXT. HARDWOOD, FIXED FRENCH, 15" TRANS.	2		
15	6'-0" x 6'-8" x 1 3/4"	EXT. HARDWOOD, SLIDING FRENCH, 15" TRANS.	1		
16	2'-9" x 6'-8" x 1 3/4"	EXTERIOR HARDWOOD, SCREEN	1		

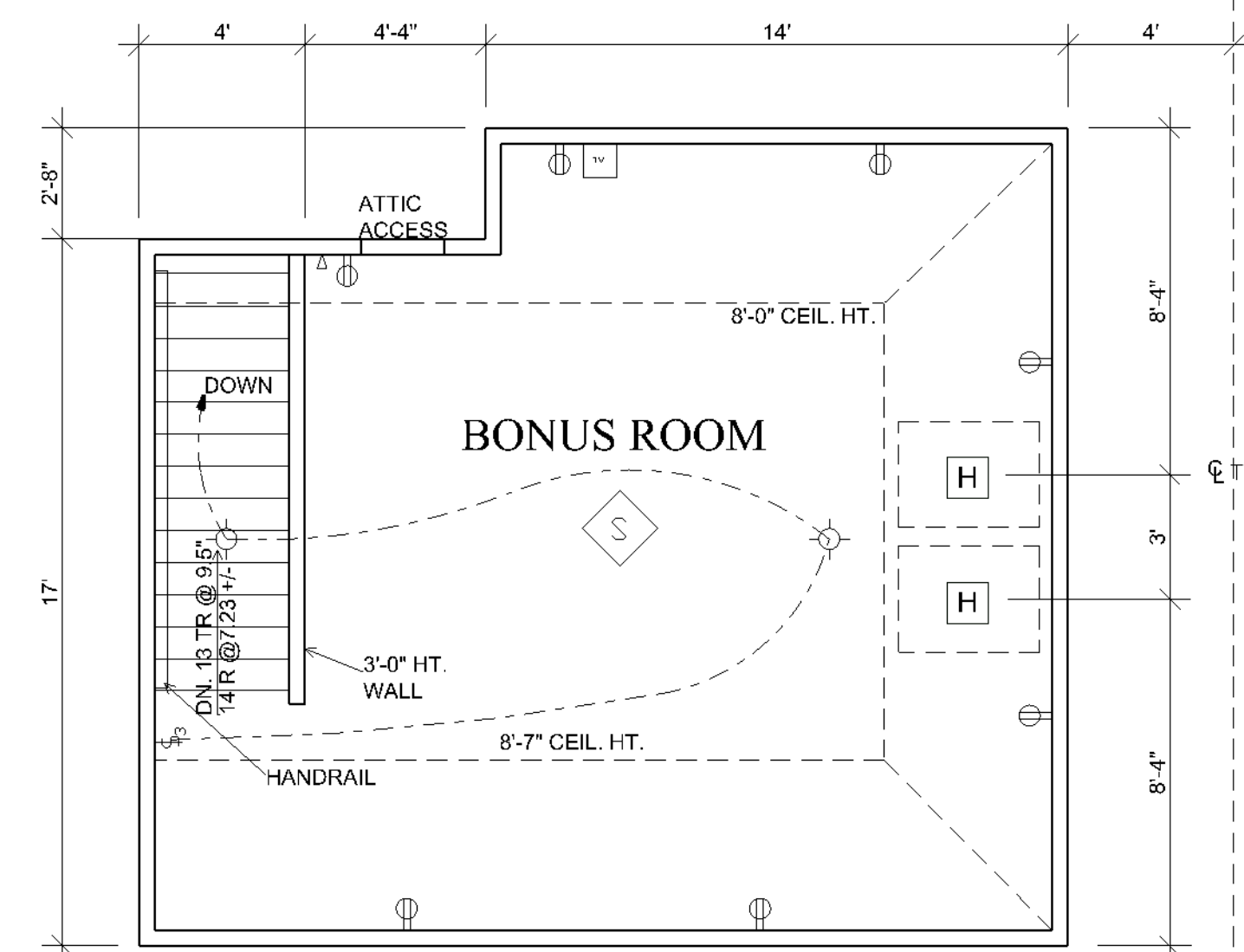

ELECTRICAL LEGEND	
SYMBOL	DESCRIPTION
	DUPLEX OUTLET (GROUNDED TYPE)
	WEATHER PROOF DUPLEX OUTLET
	WALL SWITCH CONTROLLED DUPLEX OUTLET
	ABOVE COUNTER LOCATION
	FLUSH FLOOR WALL SWITCH CONTROLLED DUPLEX OUTLET
	OWNER VERIFY LOCATION
	220 VOLT OUTLET
	TELEVISION ANTENNA / CABLE OUTLET
	TELEPHONE OUTLET LOCATION
	DOOR CHIME LOCATION
	120 VOLT JUNCTION BOX
	SINGLE POLE WALL SWITCH
	3-WAY WALL SWITCH
	CEILING MOUNTED LIGHT FIXTURE
	WALL BRACKET MOUNTED LIGHT FIXTURE
	SUSPENDED CEILING MOUNTED LIGHT FIXTURE
	RECESSED DIRECTIONAL CEILING LIGHT FIXTURE
	RECESSED CEILING LIGHT FIXTURE
	ONE TUBE UNDER COUNTER FLUORESCENT LIGHT
	EXTERIOR CAST ALUMINUM FLOOD LIGHTS
	CEILING MOUNTED FAN - PADDLE
	CEILING MOUNTED FAN, LIGHT, AND HEATER
	DOOR BELL BUTTON
	SMOKE DETECTOR

- PLAN NOTES:**
- VERIFY ALL LOCAL CODES, ENERGY TYPES, AND SITE CONDITIONS PRIOR TO CONSTRUCTION.
 - REVIEW SELECTED MECHANICAL SYSTEMS WITH OWNER PRIOR TO CONSTRUCTION. REVIEW SUB-CONTRACTOR'S LOCATIONS OF THE WATER HEATER AND HVAC UNITS) WITH THE OWNER PRIOR TO CONSTRUCTION. VERIFY LOCAL BUILDING CODE REQUIREMENTS AND MANUFACTURER REQUIREMENTS FOR ATTIC, CRAWL SPACE, OR GARAGE LOCATIONS. H.V.A.C. EQUIPMENT IN THE ATTIC SPACE SHALL BE ACCESSIBLE BY AN OPENING LARGER THAN THE LARGEST PIECE OF EQUIPMENT (TO ALLOW REMOVAL OF THE EQUIPMENT) AND IN NO CASE LESS THAN 22" x 36". SEE STRUCTURAL DRAWINGS FOR ADDITIONAL INFORMATION.
 - INSULATE AROUND ALL BATHS AND UTILITY ROOM.
 - TYPICAL WALL, 2x4's @ 16" O.C., UNLESS OTHERWISE DIMENSIONED.
 - PROVIDE SMOKE DETECTORS AS REQUIRED BY CODE.
 - PROVIDE DOORBELLS, TRANSFORMER, AND CHIME.

FLOOR PLAN

1/4" = 1'-0"

TOTAL LIVING	1977 sq.ft.
GARAGE & STORAGE	610 sq.ft.
BONUS ROOM	430 sq.ft.

GARDNER RESIDENCE
 PLAN 332

DRAWN BY: B. Brideau
 CHECKED BY: B. F.

Sheet: 3 of 7

Cadsoft
 Cadsoft Corporation
 649 Southdale Dr., Suite 200
 Guelph, Ontario
 Canada, N1G 4T7
 Phone: (519) 836 3999
 Fax: (519) 823 8821

NOT TO BE COPIED OR REPRODUCED WITHOUT WRITTEN PERMISSION. COPYRIGHT 2004. DO NOT SCALE DRAWINGS.